

Spring type: The lugs expand when received the pressure from edge of paper core by machine moveable arms and lug automatic release after pressure free from the edge of paper core when machine moveable arms opened. It is most recommend for on unwind roll stand with hydraulic arm facility.

## BENEFITS

Handles high weight. Easy to maintain and core-friendly. Reducing downtime and the risk of injury due to heavy lifting



**NEA001-3" (MAX LOAD 1.5 TONES/PC)**

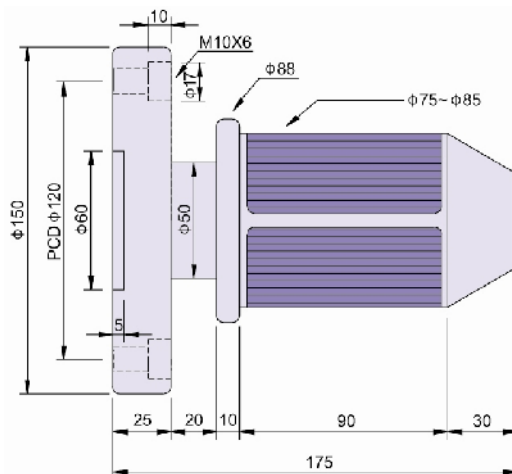

**NEA002-6" (MAX LOAD 4 TONES/PC)**

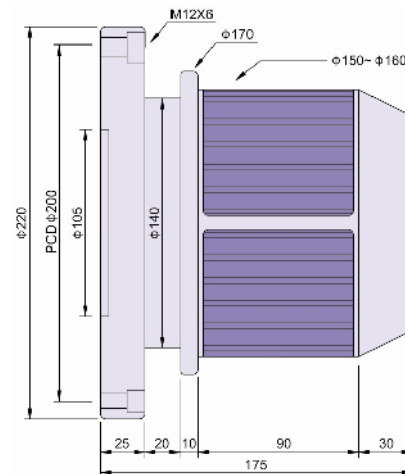

**NEA004" (MAX LOAD 800 KGS/PC)**

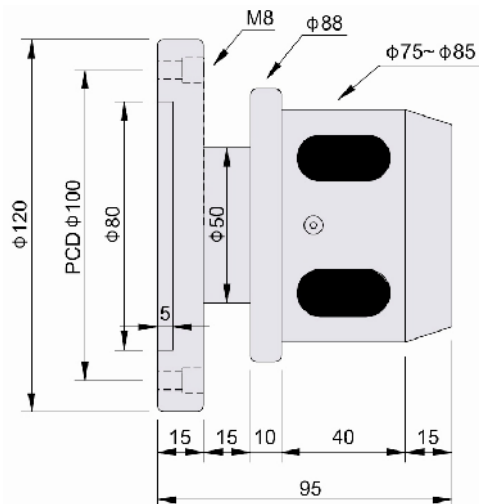

Standard sizes available for this Model are listed above, but are available in other sizes for a customer order. Also, PCD and length change are welcome.

Rotary type: The expanding elements, pin-fitted on a cam, are expanded through the reel rotation combined with the web tension. It is most recommend for on unwind roll stand without hydraulic arm facility.

## NEB 001-3" (MAX LOAD 1.2 TONES/ PC)

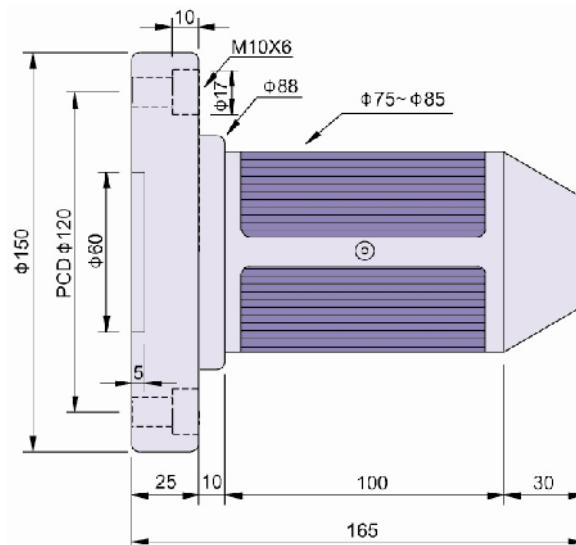

## NEB 002-6" (MAX LOAD 4 TONES/PC)

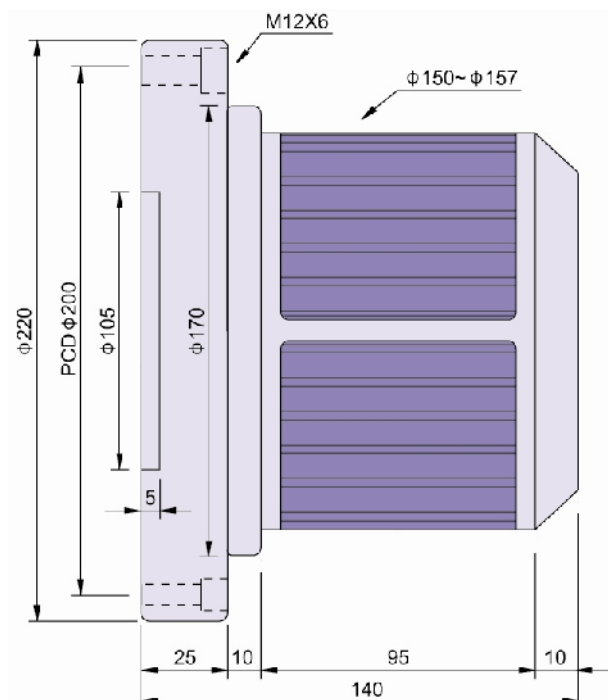

Standard sizes available for this Model are listed above, but are available in other sizes for a customer order. Also, PCD and length change are welcome.

# STEPPED MECHANICAL CHUCK

**NIKA®**

Idea to save time and cost when uses different paper cores on shaft less applications in corrugating, sheeting, paper finishing or laminating. The unique design is extremely strong, easy to maintain and core-friendly. Not require removing the chuck from machine when use different sizes of paper cores, that means increase your productivity. Always customer made product.

**SPRING TYPE: NEA 003- 3 x 6" (MAX LOAD 3" 1.5 TONES/PC)  
(MAX LOAD 6" 4 TONES/PC)**

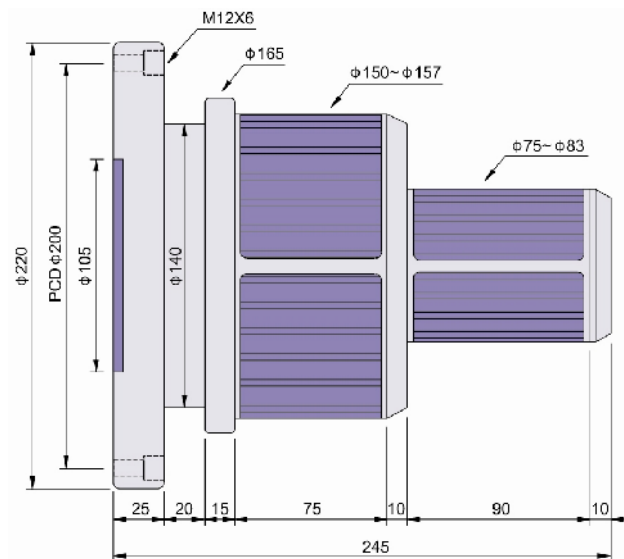

**ROTARY TYPE: NEB 003-3 X 6" (MAX LOAD 3" 1.2 TONES/PC)  
(MAX LOAD 6" 4 TONES/PC)**

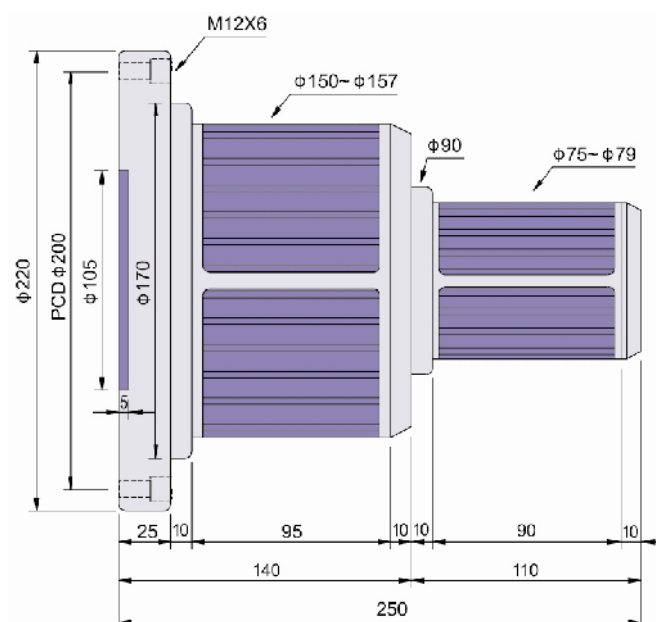

Standard sizes available for this Model are listed above, but are available in other sizes for a customer order. Also, PCD and length change are welcome.

# PNEUMATIC ADAPTER

**NIIKA®**

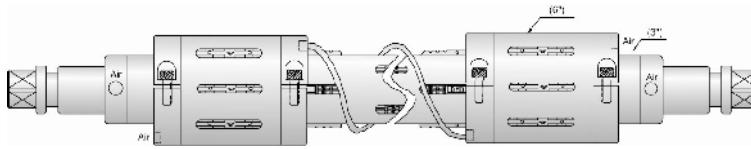

You can accommodate additional core diameters at a fraction of the cost by use pneumatic adapter. It is easier changeover and less downtime mean greater productivity at a very low cost. 5", 6" and 12" adapter can apply to 3" main shaft. With installing adapters, only 3" shaft can cover 5", 6" and 12" shaft.

## LEAF TYPE NEC001- 6"X 200

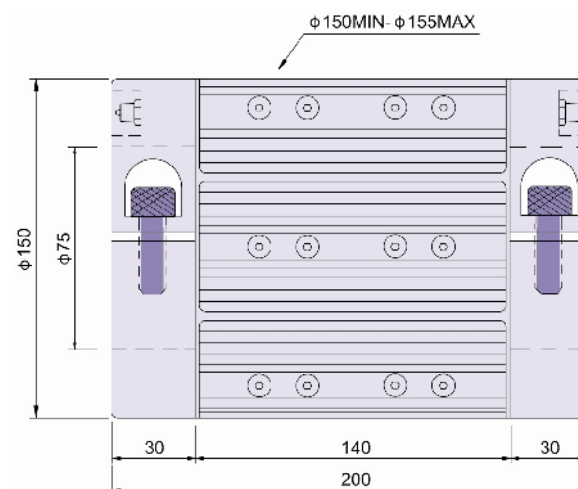

## LEAF TYPE NEC002- 6"X 300

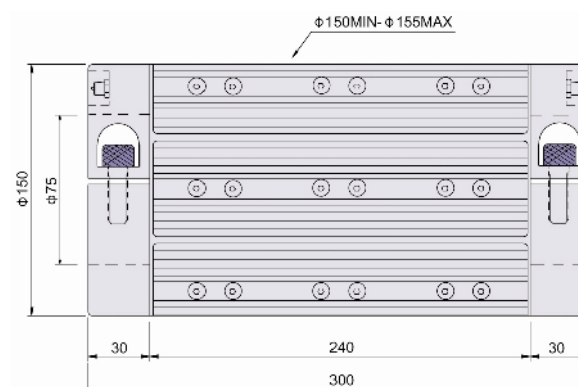

Standard sizes available for this Model are listed above, but are available in other sizes for a customer order. **Please indicate you support shaft OD when order (very important).**

## LUG TYPE

### NED001- 6"X 200

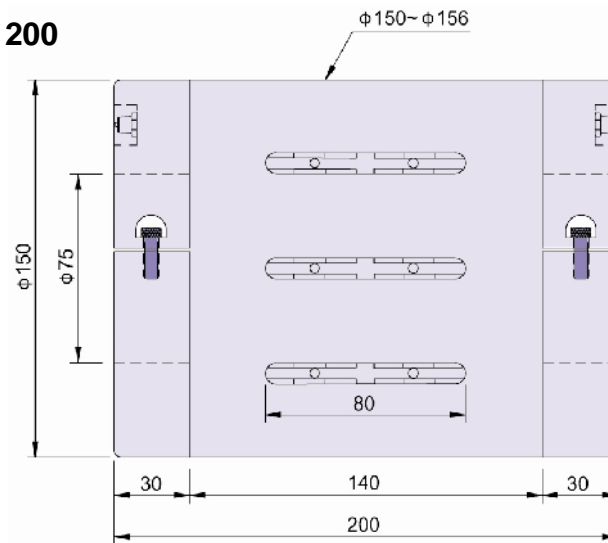

## LUG TYPE

### NED002- 6"X 300

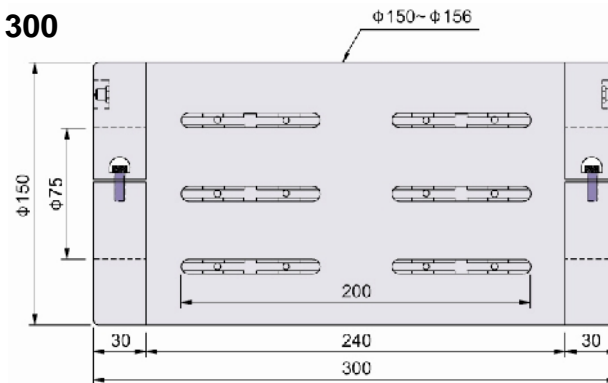

## RUBBER TYPE

### NED003- 6"X 300

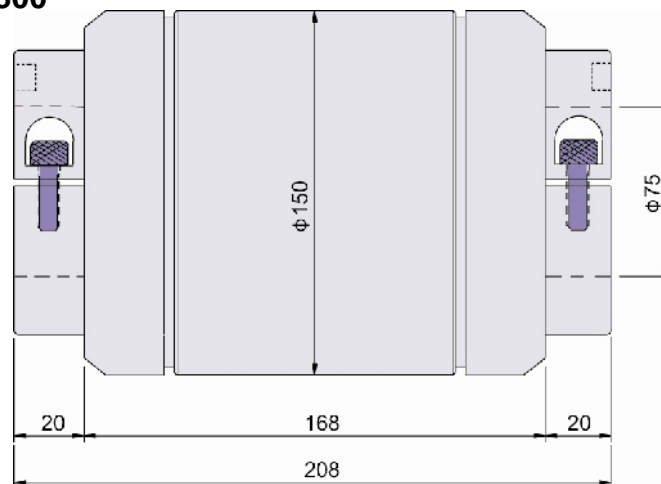

NED 003 is use on plastic core and steel core. Also the weight is 1/3 lighter then other adapters.

Standard sizes available for this Model are listed above, but are available in other sizes for a customer order. **Please indicate you 3" shaft OD when order (very important).**

Please indicate bore size when order (very important).

## NEF 001-3"

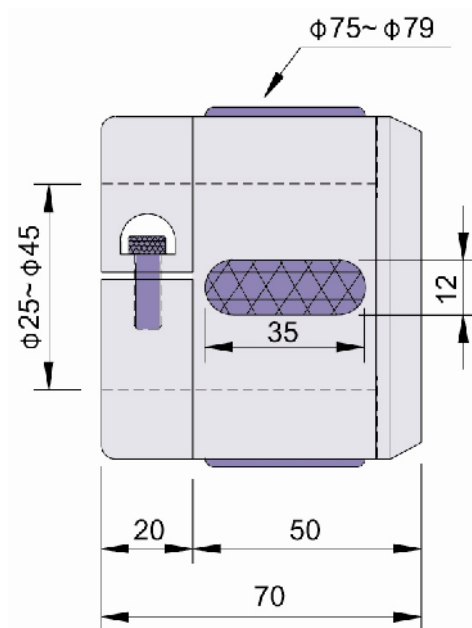

## NEF 002-6"

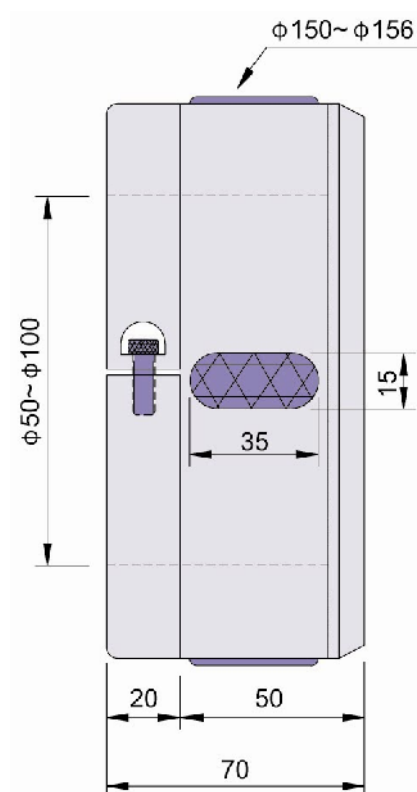

Standard sizes available for this Model are listed above, but are available in other sizes for a customer order. Also, bore and length change are welcome.

# FLANGE HOLLOW CHUCK

NIKA®

Please indicate bore size when order (very important).

## NEF 001F-3"

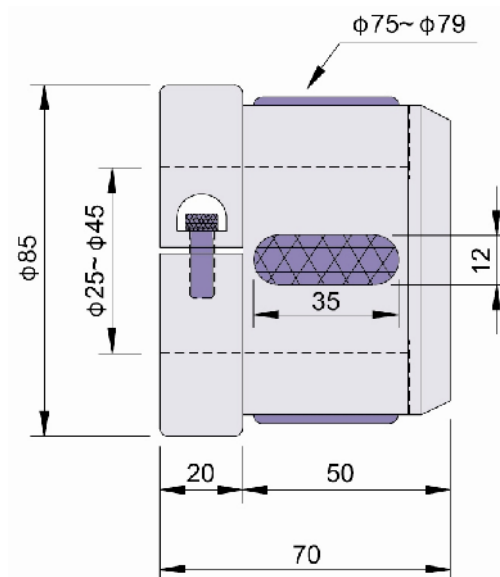

## NEF 002F-6"

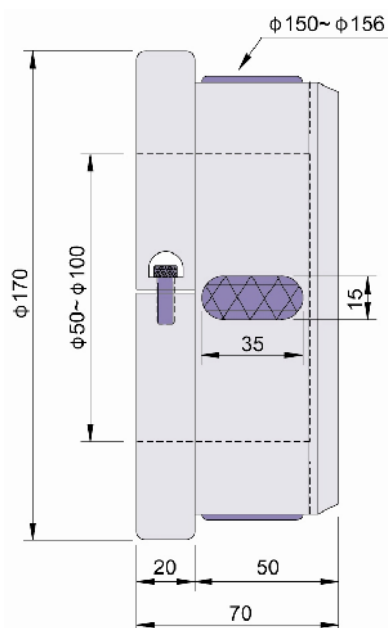

Standard sizes available for this Model are listed above, but are available in other sizes for a customer order. Also, bore and length change are welcome.

## APPLICATION

